



# CorFlo™ CMFM

CORIOLIS MASS FLOW METER



## DESCRIPTION

The CorFlo™ CMFM Coriolis Mass Flow Meters are the leading precision flow and density measurement solution offering the most accurate and repeatable mass measurement for liquids, or slurries. CorFlo™ meters offer the most accurate measurement available for virtually any process fluid, while exhibiting exceptionally low pressure drop.

## FEATURES & BENEFITS

- Unchallengeable performance on liquid mass flow, volume flow and density measurement
- Unique design delivers unparalleled measurement sensitivity and stability
- Guarantees consistent, reliable performance over the widest flow range
- Designed to minimize process, mounting, and environmental effect

## SENSOR SPECIFICATIONS

<b>Accuracy</b>	±0.1 ~ 0.5%
<b>Repeatability</b>	±0.1 ~ 0.25%
<b>Density Measurement Range</b>	0.5 ~ 2g/cm <sup>3</sup> , Accuracy: ±0.002 g/cm <sup>3</sup>
<b>Operating Temperature</b>	-58 to 392°F (min: -328 to max: 572°F)
<b>Ambient Temperature</b>	-40 to 140°F
<b>Measuring Tube Material</b>	SS316L
<b>Housing Material</b>	SS304
<b>Nominal Pressure</b>	4.0MPa ; Max:35MPa
<b>Ex-Proof Rating</b>	Ex-Proof: Exd (ia) II C T6Gb

## TRANSMITTER SPECIFICATIONS

<b>Ambient Temperature</b>	-4 ~ 140°F
<b>Display Info</b>	Mass flow: Volume flow, Density, Temperature
<b>Display Mode</b>	LCD
<b>Power Supply</b>	24VDC / 220 VAC
<b>Output Signal</b>	Pulse / 4-20mA
<b>Communication</b>	Modbus
<b>Ex-Proof Rating</b>	Ex d ib IIC T6 Gb

*Specifications subject to change*

# DIMENSIONS

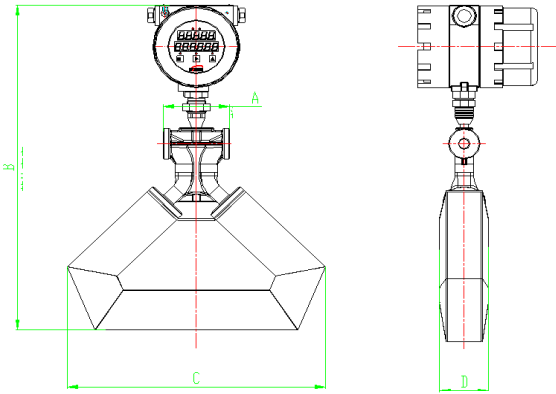

UNIT: INCHES

PART NUMBER	A	B	C	D
<b>CMFM-010</b>	17.7	23.2	14.9	2.3
<b>CMFM-015</b>	17.9	23.2	14.9	2.3

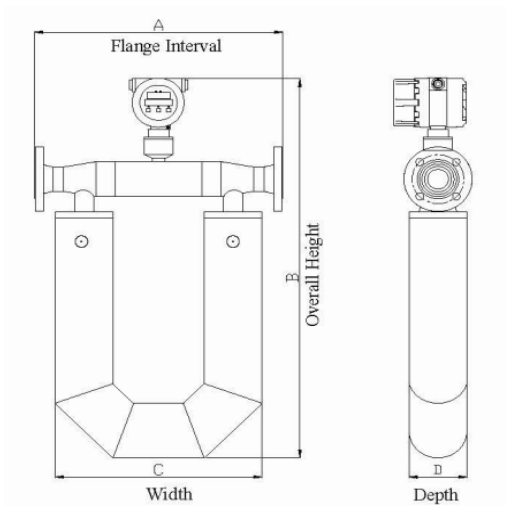

UNIT: INCHES

PART NUMBER	A	B	C	D
<b>CMFM-020</b>	21.2	29.1	18.4	4.2
<b>CMFM-025</b>	21.2	29.1	18.4	4.2
<b>CMFM-040</b>	23.6	39.7	19.6	5.5
<b>CMFM-050</b>	23.4	39.7	19.6	5.5
<b>CMFM-080</b>	34.2	53.7	30.7	8.6
<b>CMFM-100</b>	37.4	56.6	32.6	10.7
<b>CMFM-150</b>	51.1	60.6	45.0	12.7

# Ordering Information

## FLO-CORP MODEL NUMBER BUILDER

For Assistance Call **877.356.5463**

Use the diagram below, working from left to right to construct your FLO-CORP Model Number.  
Simply match the category number to the corresponding box number.

**Example:** **CMFM-050-S-N** CORFLO™ CMFM Coriolis Mass Flow Meter with 0~48~60 t/hr flow rate with a standard transmitter and NPT Process Connection.

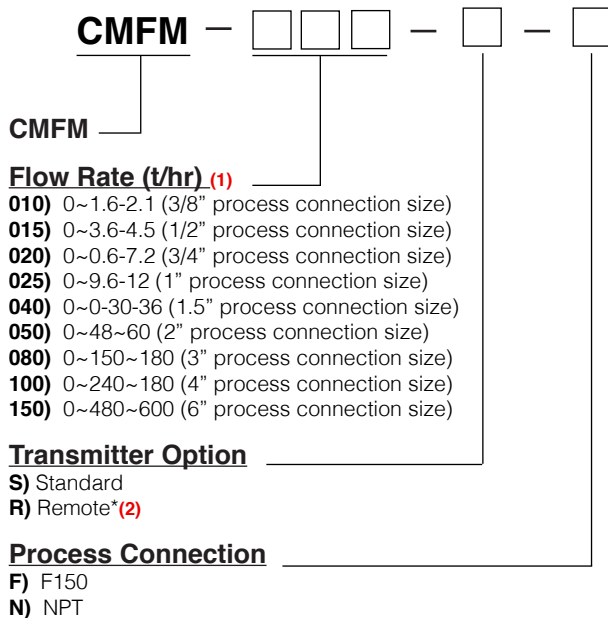

### \*REMOTE TRANSMITTER OPTION



- Mounting bracket will be equipped for remote type
- Cable length for standard configuration is 6 feet
- Use cable gland to connect transmitter and sensor (cable gland protection is IP67)

#### Ordering Notes:

- (1) Select the best configuration based on your requirements
- (2) Specify cable length required, standard = 6 feet