



# Vibex 2000™ LSV2

VIBRATING LEVEL SWITCH



## DESCRIPTION

The Vibex 2000™ vibrating level switch is an ideal instrument for accurate point level detection in solids. When the vibrating rod is immersed in the product, the vibration frequency change is detected by the integrated electronics module and converted into a switching command. If the vibrating rod is not covered by solids, its natural resonant frequency changes back and so does the state of the switching output. The ideal rod design ensures a reliable function in solid applications. Typical applications include bulk solids such as non-adhesive powders, plastic granules, pellets and fine-grained bulk solids.

## SPECIFICATIONS



<b>Measuring Range</b>	Bulk solids from 20 g/l
<b>Process Fitting</b>	Threaded 1" NPT
<b>Process Temperature</b>	-50°F to 482°F (-50 to 250°C)
<b>Process Pressure</b>	-14.5 psig to 232 psig
<b>SIL Qualification</b>	Optionally up to SIL2
<b>Wetted Parts</b>	316L Stainless Steel
<b>Housing</b>	Aluminum die-casting powder coated and primed
<b>Weight</b>	69 oz.
<b>Max. Lateral Load</b>	214 lbs ft
<b>Output</b>	Relay Output (DPDT) 2 floating spds
<b>Voltage Supply</b>	20 - 253 VAC, 50/60 Hz, 20 - 72 VDC
<b>Power Consumption</b>	1-8VA, Approx 1.3 W (DC)
<b>Turn-on Voltage</b>	min: 10mV, max: 253 VAC, 253 VDC
<b>Switching Current</b>	min: 10 uA, max: 3 A AC, 1 A DC
<b>Delay Time Approx:</b>	When immersed: 0.5s, empty/bare: 1s

Note: Specifications subject to change

## FEATURES & BENEFITS

- Simple setup without adjustment
- Product-independent switching point
- Insensitive to build up
- Wear and maintenance free
- Robust and reliable
- Detection of bulk solids from 0.0007 lbs/in
- Ability to sense very low bulk solid densities down to 20 g/l
- Easy setup even without filling or emptying the bin or silo
- Insensitive to buildup

## DIMENSIONS

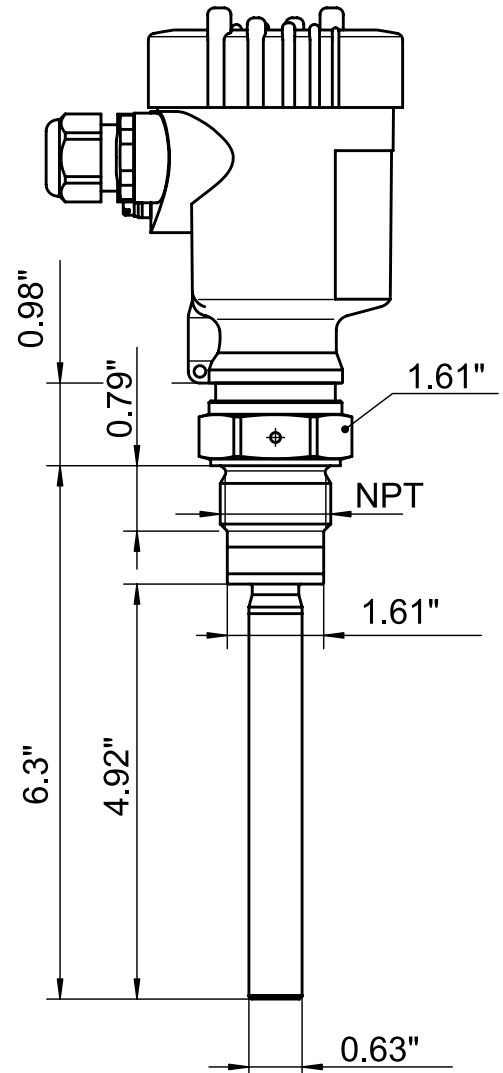

## Ordering Information

**FLO-CORP MODEL NUMBER BUILDER**

For Assistance Call **(877) 356-5463**

Use the diagram below, working from left to right to construct your FLO-CORP Model Number.  
Simply match the category number to the corresponding box number.

**Example: LSV2-01**

*Vibex™ 2000 Vibrating Level Switch for Solids with Threaded 1" NPT Process Fitting*

